

The Ruins, Cherkley Estate, Leatherhead

Agricultural Land Classification

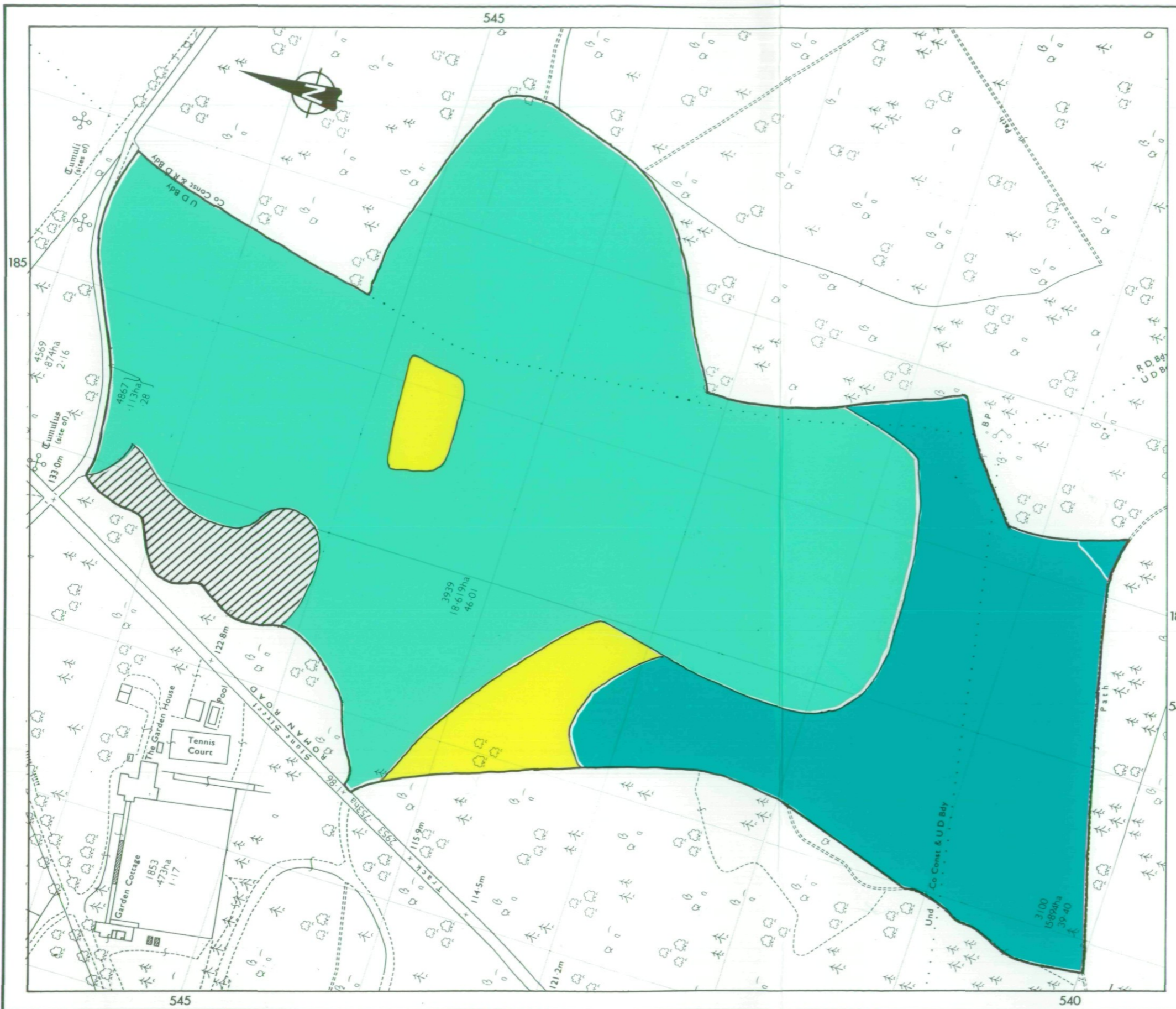

AGRICULTURAL LAND				
Grade	Quality	Area	% of Total	
Grade 1	Not present	excellent	ha	%
Grade 2	Not present	very good	ha	%
Grade 3a	good	4.37 ha	67 %	
Grade 3b	moderate	0.91 ha	6 %	
Grade 4	poor	10.82 ha	27 %	
Grade 5	Not present	very poor	ha	%

Total area of agricultural land ha

- Agricultural buildings Not present
- Woodland Not present
- Not surveyed

- ### NON-AGRICULTURAL LAND
- Land predominantly in urban use Not present
 - Land in non-agricultural use Not present

Total area of site 16.74 ha

For further information consult "Agricultural Land Classification of England and Wales (Revised guidelines and criteria for grading the quality of agricultural land)", M.A.F.F., 1988.

SOURCE MAPS
TQ 1853-1953
1854-1954



Surveyed by the Resource Planning Group 4/89
Map compiled and produced by the Cartographic Unit,
Farm and Countryside Service, South East Region, Reading.
Reference no. 07/89

Ordnance Survey information reproduced with the sanction of the Controller, H.M.S.O.

Reproduction of this map in whole or in part is prohibited without the prior permission of M.A.F.F.

This map is accurate only at the scale shown.

