

Agricultural Land Classification

HAMBLETON DISTRICT PLAN

Sites 79A, 79B and 79C

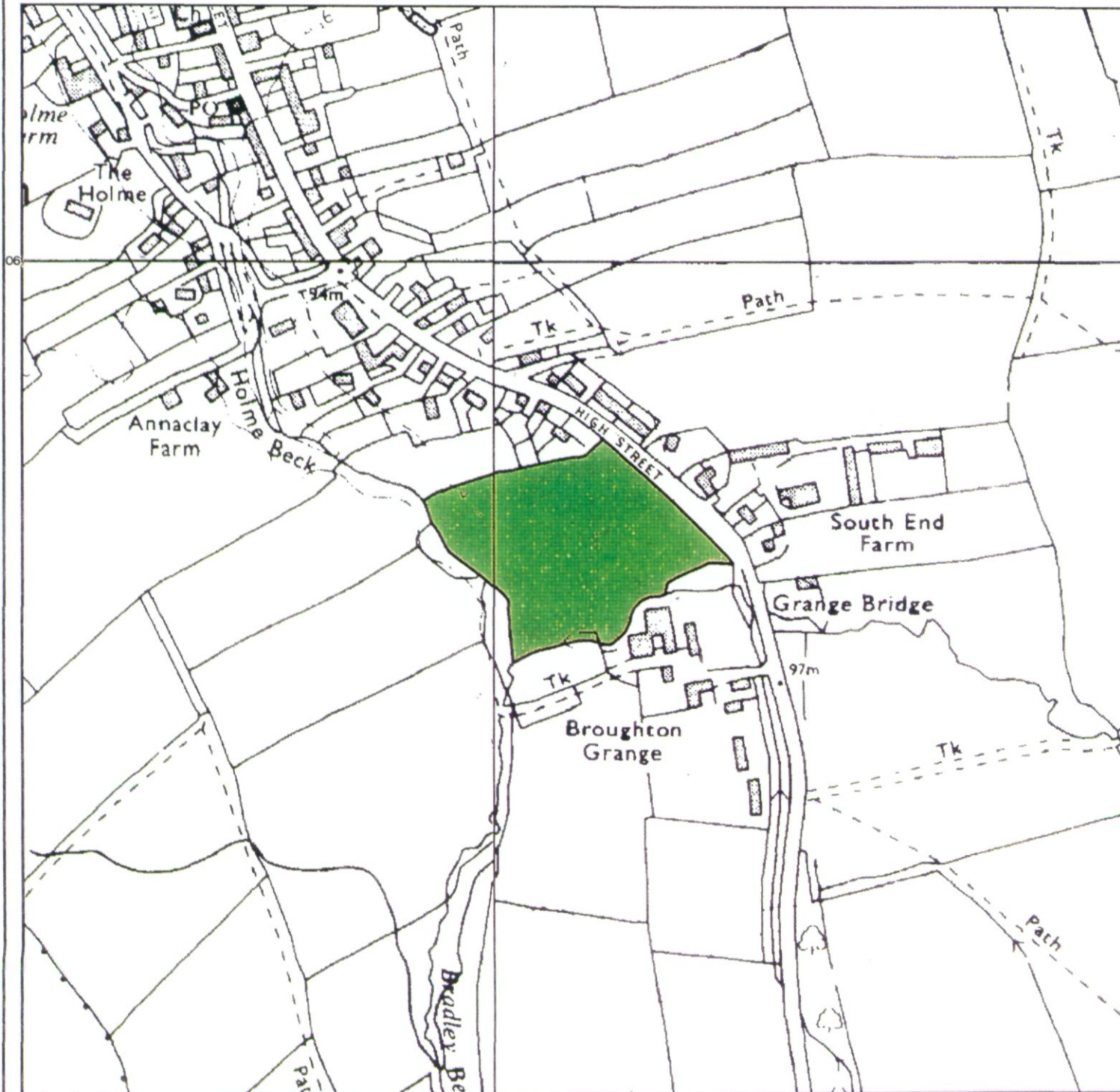

Agricultural Land

| Grade | Quality | Area (ha) |
|-------|-----------|-----------|
| 1 | Excellent | Nil |
| 2 | Very Good | Nil |
| 3a | Good | Nil |
| 3b | Moderate | 2.9 |
| 4 | Poor | Nil |
| 5 | Very Poor | Nil |

Other Land Categories

| Category | Area (ha) |
|------------------------|-----------|
| Urban | Nil |
| Non-Agricultural | Nil |
| Woodland | Nil |
| Agricultural Buildings | Nil |
| Open Water | Nil |
| Not Surveyed | Nil |

Total agricultural land area 2.9
Total survey area 2.9

* Grade/category not present within survey area

Scale - 1:5,000



Further details contained in MAFF (1988) Agricultural Land Classification of England and Wales - Revised guidelines and criteria for grading the quality of agricultural land. MAFF (Publications), London SE99 7TP.

The information is accurate at the basic map scale but any enlargement would be misleading.

Reproduction in whole or in part by any means is prohibited without the prior permission of MAFF.

Surveyed and drawn by the Resource Planning Team, ADAS Statutory Unit Leeds

Based on the 1971 Ordnance Survey 1:50,000 map with the permission of the

Controller of Her Majesty's Stationery Office.

Source Map(s): NZ 50 NW, NZ 50 NE.

Reference no. 125/95, 142/95 & 126/95.

© Crown Copyright Reserved 1995

455

125/95

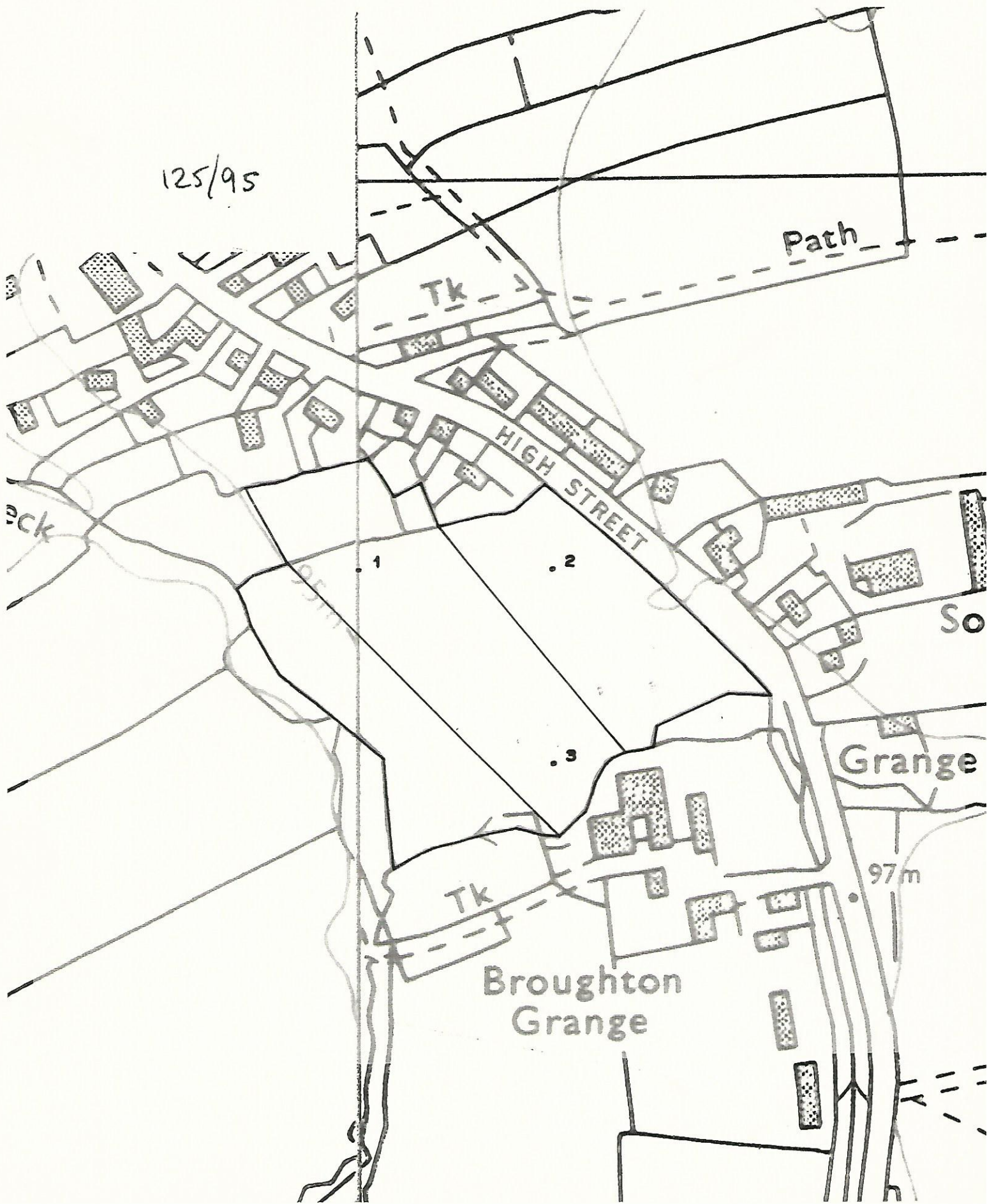

Path

Tk

HIGH STREET

beck

So

Grange

Tk

Broughton Grange

97m

95m

1

2

3